

National Gallery of Art

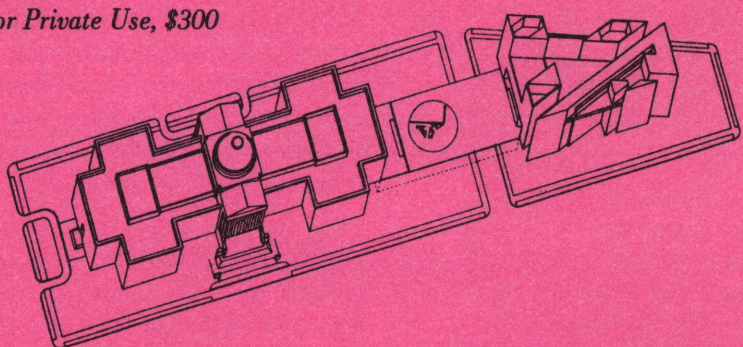





Washington, D.C. 20565

Official Business
Penalty for Private Use, \$300



CALENDAR OF EVENTS

April 1982

	Tours and Paintings of the Week	Introductory Tours	Films	Sunday Lectures	Sunday Concerts
<p>MONDAY, March 29 through SUNDAY, April 4</p> 	<p><i>Rodin Rediscovered: An Overview of the Exhibition</i> Tues. through Sat. 1:00 Sun. 2:30 East Building Ground Floor Lobby</p> <p>Pablo Picasso <i>Le Gourmet</i> (Chester Dale Collection) Tues. through Sat. 12:00 & 2:00; Sun. 3:30 & 6:00 East Building Upper Level</p>	<p><i>Introduction to the East Building's Collection</i> Mon. through Sat. 11:00 Sun. 1:00 East Building Ground Floor Lobby</p> <p><i>Introduction to the West Building's Collection</i> Mon. through Sat. 3:00 Sun. 5:00 West Building Rotunda</p>	<p><i>Rodin: The Gates of Hell</i> (53 min.) Mon. through Fri. 11:00 12:30, 2:00 & 3:00 Sat. 11:00 Sun. 12:15 & 6:00</p> <p><i>Paisà</i>, directed by Roberto Rossellini (124 min.) Fri. 6:00 (East Building doors open 5:30) Sat. 12:30</p> <p>East Building Auditorium</p>	<p><i>Successive Concepts of Gothic Space: Notre Dame de Paris and Chartres</i></p> <p><i>Speaker:</i> Jean Bony Kress Professor National Gallery of Art</p> <p>Sunday 4:00</p> <p>East Building Auditorium</p>	<p>National Gallery Orchestra Richard Bales, <i>Conductor</i> Robert Barlow, <i>Harpist</i></p> <p>West Building East Garden Court 7:00</p>
<p>MONDAY, April 5 through SUNDAY, April 11</p> 	<p><i>Painting in the Time of Rodin</i> Tues. through Sat. 1:00 Sun. 2:30 West Building Rotunda</p> <p>Sebastiano Ricci <i>The Last Supper</i> (Samuel H. Kress Collection) Tues. through Sat. 12:00 & 2:00; Sun. 3:30 & 6:00 West Building Gallery 29</p>	<p><i>Introduction to the East Building's Collection</i> Mon. through Sat. 11:00 Sun. 1:00 East Building Ground Floor Lobby</p> <p><i>Introduction to the West Building's Collection</i> Mon. through Sat. 3:00 Sun. 5:00 West Building Rotunda</p>	<p><i>Rembrandt's Three Crosses</i> (15 min.) and <i>The Open Window</i> (18 min.) Tues. through Sat. 12:30 Sun. 1:15</p> <p><i>Rodin: The Gates of Hell</i> (53 min.) Mon. through Fri. 11:00 2:00 & 3:00 Sat. 11:00 & 2:00 Sun. 12:15 & 6:00</p> <p><i>A Human Voice</i> and <i>The Miracle</i>, directed by Roberto Rossellini (70 min.) Fri. 6:00 (East Building doors open 5:30) Sat. 3:00</p> <p>East Building Auditorium</p>	<p><i>Dutch Figure Drawings from the Seventeenth Century</i></p> <p><i>Speaker:</i> Peter Schatborn Curator of Drawings Rijksmuseum Amsterdam The Netherlands</p> <p>Sunday 4:00</p> <p>East Building Auditorium</p> 	<p>Mary Findley, <i>Violinist</i> Alan Mandel, <i>Pianist</i></p> <p>West Building East Garden Court 7:00</p>
<p>MONDAY, April 12 through SUNDAY, April 18</p> 	<p><i>Kongo Art in Two Worlds: An Overview of the Exhibition</i> Tues. through Sat. 1:00 Sun. 2:30 East Building Ground Floor Lobby</p> <p>Paul Klee <i>Capriccio in February</i> (Lent by The Morton G. Neumann Family Collection) Tues. through Sat. 12:00 & 2:00; Sun. 3:30 & 6:00 East Building Upper Level</p>	<p><i>Introduction to the East Building's Collection</i> Mon. through Sat. 11:00 Sun. 1:00 East Building Ground Floor Lobby</p> <p><i>Introduction to the West Building's Collection</i> Mon. through Sat. 3:00 Sun. 5:00 West Building Rotunda</p>	<p><i>Rodin: The Gates of Hell</i> (53 min.) Mon. through Thurs. 11:00 2:00 & 3:00 Sun. 12:15 & 6:00</p> <p><i>Legacy: Andrew W. Mellon Remembered</i> (58 min.) and <i>The National Gallery Builds</i> (13 min.) Wed. & Thurs. 12:30 Sun. 1:15</p> <p><i>Voyage in Italy</i>, directed by Roberto Rossellini (75 min.) Fri. 6:00 (East Building doors open 5:30) Sun. 7:00</p> <p>East Building Auditorium</p>	<p><i>The Early American Seascape and Its Anglo-Dutch Models</i></p> <p><i>Speaker:</i> Alfred G.H. Bachrach Professor (Emeritus) of English Literature Universities of Leiden and Amsterdam The Netherlands</p> <p>Sunday 4:00</p> <p>East Building Auditorium</p>	<p>National Gallery Orchestra Richard Bales, <i>Conductor</i> Frederick Koch <i>Composer-Pianist</i></p> <p>West Building East Garden Court 7:00</p>
<p>MONDAY, April 19 through SUNDAY, April 25</p> 	<p><i>Pre-Columbian Art of Costa Rica: An Overview of the Exhibition</i> Tues. through Sat. 1:00 Sun. 2:30 East Building Ground Floor Lobby</p> <p>Master of the Saint Lucy Legend <i>Mary, Queen of Heaven</i> (Samuel H. Kress Collection) Tues. through Sat. 12:00 & 2:00; Sun. 3:30 & 6:00 West Building Gallery 40</p>	<p><i>Introduction to the East Building's Collection</i> Mon. through Sat. 11:00 Sun. 1:00 East Building Ground Floor Lobby</p> <p><i>Introduction to the West Building's Collection</i> Mon. through Sat. 3:00 Sun. 5:00 West Building Rotunda</p>	<p><i>Rodin: The Gates of Hell</i> (53 min.) Mon. through Fri. 11:00 2:00 & 3:00 Sat. 11:00 & 2:00 Sun. 12:15 & 6:00</p> <p><i>Legacy: Andrew W. Mellon Remembered</i> (58 min.) and <i>The National Gallery Builds</i> (13 min.) Mon. through Sat. 12:30 Sun. 1:15</p> <p><i>India</i>, directed by Roberto Rossellini (90 min.) Fri. 6:00 (East Building doors open 5:30) Sat. 3:00</p> <p>East Building Auditorium</p>	<p><i>Dutch Paintings from the Royal Picture Gallery The Hague</i></p> <p><i>Speaker:</i> Frits J. Duparc Curator of Paintings Mauritshuis, The Hague The Netherlands</p> <p>Sunday 4:00</p> <p>East Building Auditorium</p> 	<p>Roy Hamlin Johnson <i>Pianist</i></p> <p>West Building East Garden Court 7:00</p>

National Gallery of Art

Washington, D.C. 20565

The telephone number for general information is (202) 737-4215.

Legacy: Andrew W. Mellon Remembered is a 58-minute historical and dramatic film about the Gallery's founder. The biography spans the Harding, Coolidge, Hoover, and Roosevelt administrations. Underwritten by Conoco Inc., this film was produced by Byron H. McKinney, written and directed by DeWitt Sage, Jr., and is a production of Francis Thompson Inc. Please check listings on reverse side.

Roberto Rossellini Film Series: A survey of this Italian director's work will be featured for six weeks, April 2 through May 7. See lists on the opposite side of the page. Rossellini scholar Peter Brunette will introduce the films on Fridays.

The Gallery is located between 3rd and 7th Streets, Northwest, on Constitution Avenue. The East and West Buildings are connected by an all-weather underground passage with a moving walkway. Entrances to the West Building are on the Mall, on Constitution Avenue at 6th Street, which has a ramp for the handicapped, and off 4th Street. The entrance to the East Building is on 4th Street off National Gallery Plaza and also has a ramp for the handicapped.

Gallery Hours: The Gallery is open 10 a.m. to 5 p.m. Monday through Saturday. Sunday hours remain the same throughout the year: 12 noon to 9 p.m.

EXHIBITIONS

April 1982

Dutch Figure Drawings from the Seventeenth Century

April 11 through June 13, 1982
Mezzanine
East Building

Over 100 figure drawings and watercolors by Rembrandt van Rijn, Hendrick Avercamp, Hendrick Goltzius, Willem Buytewech, Adriaen van Ostade, and other 17th-century Dutch artists constitute the first exhibition devoted specifically to this subject. Organized



Saskia Sleeping in Bed
REMBRANDT VAN RIJN
The Ashmolean Museum, Oxford

by the print room of the Rijksmuseum, Amsterdam, in conjunction with the National Gallery, the exhibition includes more than 50 works from the Rijksmuseum's collection of drawings, as well as examples from other major museums and private collections in Europe and the United States.

An illustrated catalogue written by Peter Schatborn, Curator of Drawings at the Rijksmuseum, accompanies the exhibition. Mr. Schatborn will deliver a lecture on the exhibition on Sunday, April 11, in the East Building auditorium. (Check listings for details.)

Mauritshuis: Dutch Painting of the Golden Age from the Royal Picture Gallery, The Hague

April 23 through October 31, 1982
Upper level
East Building

This exhibition of 40 outstanding examples of 17th-century Dutch painting from the Mauritshuis, the Royal Picture Gallery of The Netherlands, includes pictures by Johannes Vermeer, Frans Hals, Rembrandt van Rijn, Jacob van Ruisdael, Jan Steen, and other masters. It coincides with the bicentennial anniversary of Dutch-American diplomatic relations and the temporary closing of the Mauritshuis for renovation. Originally built as a residence for Prince Johan Maurits of the House of Orange, the Mauritshuis is one of the best loved museums in Europe. Its paintings are known for their consistently high quality, even those by lesser known artists.



Head of a Girl
JOHANNES VERMEER
Mauritshuis, The Hague

An illustrated catalogue containing scholarly entries by Dr. H. R. Hoetink, Director of the Mauritshuis, accompanies the exhibition.

After its premiere at the National Gallery, the exhibition will travel to the Kimbell Art Museum, Ft. Worth, Texas (November 20, 1982-January 30, 1983); the Art Institute of Chicago (February 26, 1983-May 29, 1983); and the Los Angeles County Museum of Art (June 30, 1983-September 11, 1983).

This exhibition has been made possible at the National Gallery of Art by General Telephone & Electronics Corporation, and is supported by a Federal indemnity from the Federal Council on the Arts and the Humanities.

Dr. Hoetink will deliver a lecture entitled *Dutch Paintings from the Royal Picture Gallery, The Hague* on Sunday, April 25, in the East Building auditorium. (Please check listings for details.)

CONTINUING EXHIBITIONS

Lessing J. Rosenwald: Tribute to a Collector

Through May 9, 1982
Ground level
East Building

One hundred works of graphic art have been selected to show the development of Rosenwald as a collector.

Rodin Rediscovered

Upper level
extended through April 22, 1982
Mezzanine
extended through April 11, 1982
Ground level and Concourse
extended through May 2, 1982

This exhibition includes 250 examples of sculpture and drawings by the French artist Auguste Rodin (1840-1917) and is made possible by generous support from the IBM Corporation.



East Building central courtyard

Between Continents-Between Seas: Precolumbian Art of Costa Rica

Through May 2, 1982
Concourse level
East Building

On view are 300 examples of Costa Rica's Precolumbian art dating from c. 500 B.C. to the 16th century A.D.

The Four Moments of the Sun: Kongo Art in Two Worlds

Extended through May 30, 1982
Ground level
East Building

Sixty examples of funerary art from the central African civilization of Kongo in Bas-Zaïre are shown.

The Gallery's 39th American Music Festival begins Sunday, April 4, with the National Gallery Orchestra, Richard Bales, Conductor. This annual festival is devoted entirely to works of American composers dating from colonial times to the present day. The Festival concerts are presented in the East Garden Court, West Building, at 7 p.m. each Sunday through May 23. The American Music Festival concerts are broadcast live on Station WGMS 570 AM and 103.5 FM, and are being recorded for later broadcast by National Public Radio.



The Twelfth Annual Middle Atlantic Symposium in the History of Art will be held on April 17 in the East Building auditorium. Papers on topics ranging from the late classical period to the modern era will be delivered by selected graduate students from universities in Maryland, Delaware, Pennsylvania, Virginia, North Carolina, and Washington, D.C. The sessions will begin at 10:00 a.m. and 2:30 p.m. The symposium, sponsored by the Department of Art, University of Maryland, is under the auspices of the Gallery's Center for Advanced Study in the Visual Arts.